

OPERATING INSTRUCTIONS

IMPORTANT

NEVER ATTEMPT TO OPERATE A LAMP WITHOUT REFLECTOR (4) AND GASKET (8) AND CONTROL STEM (6) PROPERLY ASSEMBLED.

ASSEMBLING LAMP: If Reflector (4) is not pre-assembled, fasten it to the lamp with the reflector nut (2), contained in the envelope, making sure groove in nut **faces out**. Install Burner Tip (3) and pound in tight using wood block or other protection to avoid damage to lava face. — Assemble hook or handle (11, 13 or 14) to back of lamp and tighten cap nuts (15) securely.

BEFORE USING: Become familiar with operation of water control. Remove water container (7), fill with water (remove water plug 12), dry exterior and operate Control Stem (6) to determine "off" position (mark knob) and best "on" position (where water is released in a slow series of drops). Note how much knob was turned from "off" to reach this setting.

TO LOAD: Fill Carbide Container with lamp size Carbide (Calcium Carbide in pebble form) up to Fill Level line. Fill Water Container (7) $\frac{3}{4}$ full. Turn Control (6) off. Replace water container, tighten securely.

TO LIGHT: Open control (6) about one turn. Allow 15 seconds to accumulate gas. Light with lighter attachment (5) or match. Adjust flame by turning control.

TO SHUT OFF: Turn Control (6) to off. Allow flame to burn almost out then blow out the small flame.

IMPORTANT SUGGESTIONS: Keep Burner Tip (3) clean. Use Tip Cleaner, Tip Reamer or Cleaning Wire **attached below** frequently to keep hole clear.

CLEANING WIRE FOR BURNER TIP



(Clean Tip Often)

Never operate lamp with control wide open. Excess water produces surplus gas causing "bubbling" in water and loss of gas. Dump out the carbide residue (lime) before refilling container.

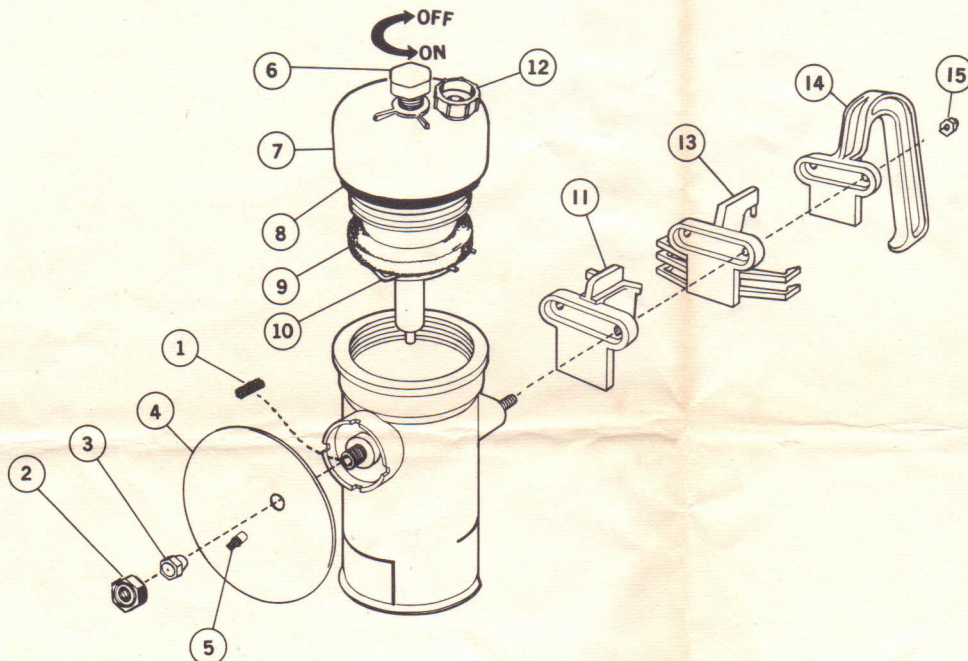

REPLACEMENT PARTS

1. Felt No. 5-308
2. Reflector Nut No. 5-197
3. Burner Tip No. 5-128
4. Reflector — $2\frac{1}{2}$ " — No. 5-602
4" — No. 5-604
7" — No. 5-136
5. Lighter Attachment No. 5-177
6. Control Stem No. 5-336
7. Water Container
8. Gasket No. 5-332
9. Filter No. 5-331
10. Filter Holder
11. Flat Hook
12. Water Fill Plug No. 5-309
13. Round Hook
14. Back Handle
15. Cap Nut
- Tip Cleaner No. 5-037
- Tip Reamer No. 5-248

THE CARBIDE LAMP

Calcium Carbide is a unique solid. When water contacts it, it releases a highly efficient illuminating gas. In the carbide lamp the gradual, easily controlled release of water generates gas slowly and evenly so that an intensely bright flame can be sustained for many hours. The lamp is not a sealed system and gas pressure is safely low. The residue from the used carbide is a high grade lime useful as whitewash, as a soil conditioner, etc.